

NORWEGIAN BREAKAWAY/GETAWAY

Deck plans shown are of Norwegian Breakaway. The deck plans of Norwegian Getaway differ slightly from the staterooms, categories and public areas shown below. Deck plans and information subject to change. For the latest details see www.ncl.eu.

FOR FURTHER INFORMATION ON OUR FLEET SEE PAGES 66-77.

SYMBOLS

- With facilities for the disabled
- ↔ Connecting staterooms
- ▲ 3rd guest occupancy avail.
- + 3rd/4th guest occupancy avail.
- ★ 3rd/4th/5th guest occupancy avail.
- ☆ Up to 6th guest occupancy avail.
- ✕ Elevator RR Restroom

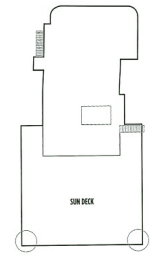

Deck 18

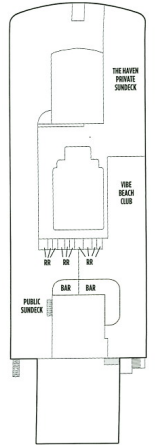

Deck 17

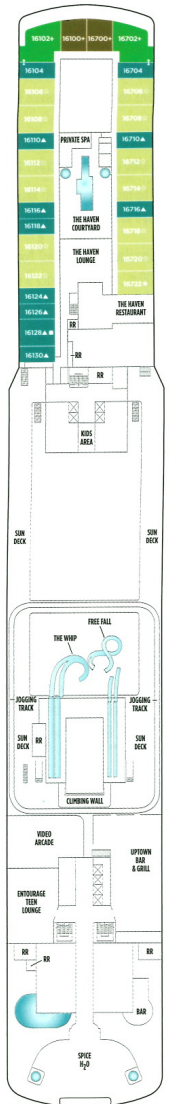

Deck 16

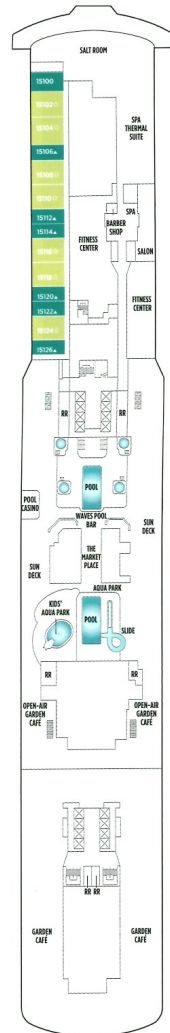

Deck 15

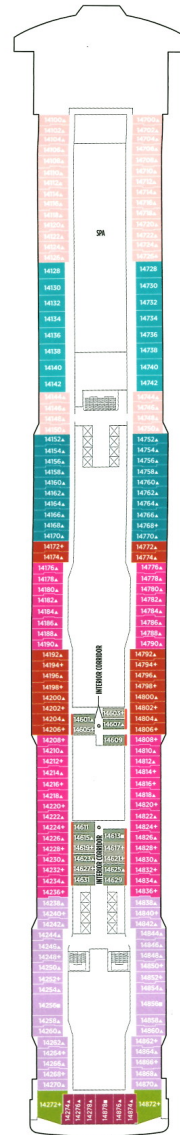

Deck 14

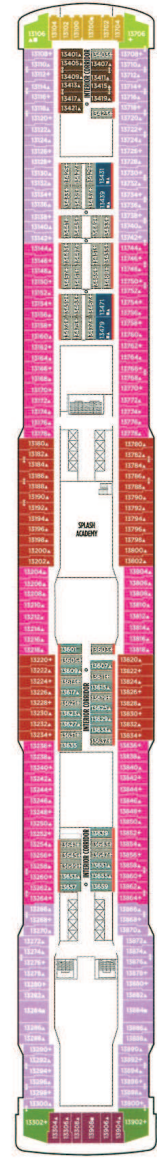

Deck 13

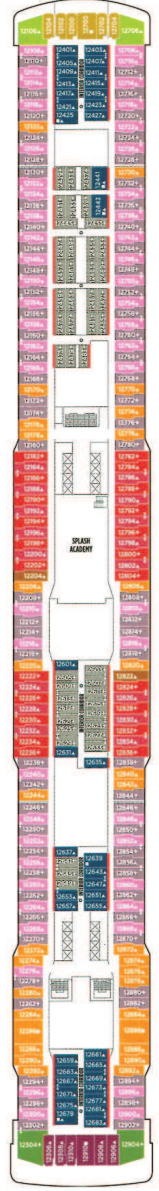

Deck 12

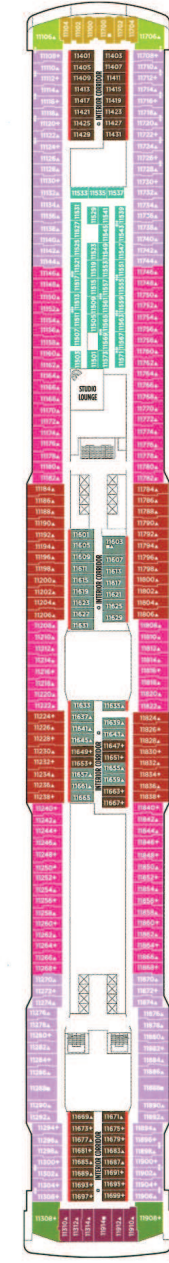

Deck 11

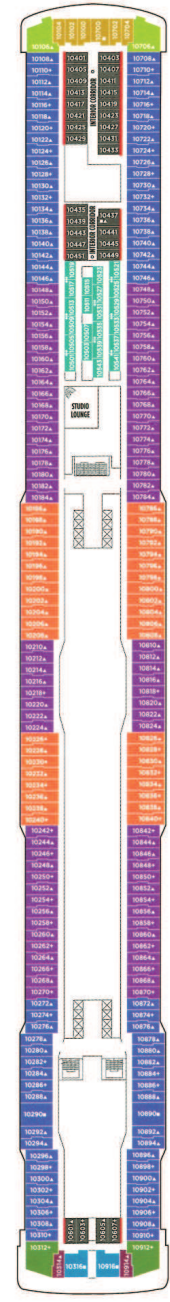

Deck 10

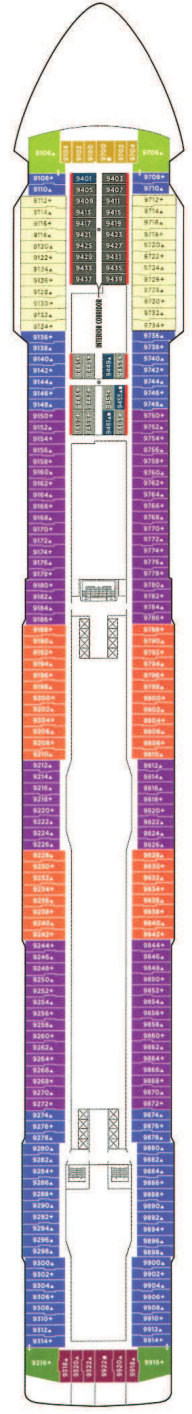

Deck 9

NORWEGIAN BREAKAWAY/GETAWAY

Deck plans shown are of Norwegian Breakaway. The deck plans of Norwegian Getaway differ slightly from the staterooms, categories and public areas shown below. Deck plans and information subject to change. For the latest details see www.ncl.eu.

FOR FURTHER INFORMATION ON OUR FLEET SEE PAGES 66-77.

SYMBOLS

- With facilities for the disabled
- ↔ Connecting staterooms
- ▲ 3rd guest occupancy avail.
- + 3rd/4th guest occupancy avail.
- ★ 3rd/4th/5th guest occupancy avail.
- ☆ Up to 6th guest occupancy avail.
- ✕ Elevator RR Restroom

- Indicates stateroom categories that can accommodate three or more guests.

STATEROOM FEATURES

All staterooms aboard N. Breakaway/Getaway have a phone, TV, air conditioning, refrigerator*, safe, duvet, bathroom with shower and hair dryer. All lower beds are convertible to a queen-size bed.

Quoted stateroom sizes include balconies where applicable.
*Not available in Studios, category T1.

DETAILED CATEGORY DESCRIPTIONS:
www.ncl.eu

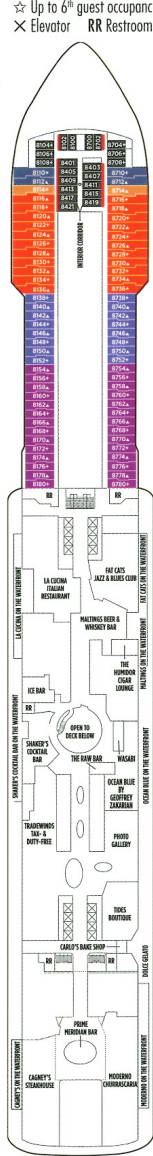

Deck 8

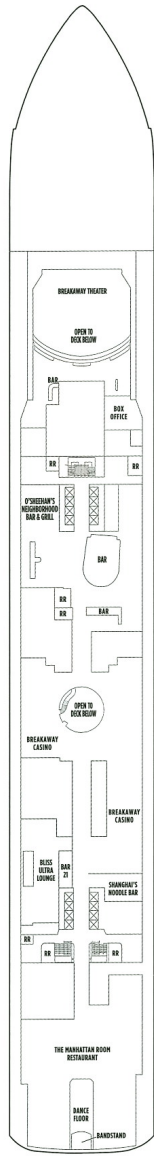

Deck 7

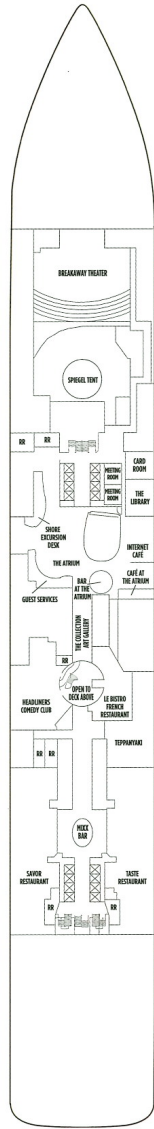

Deck 6

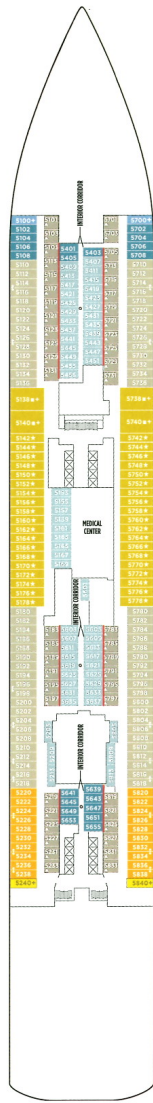

Deck 5



Access to The Haven Courtyard with pool, hot tubs and private sun deck.



Access to The Haven Courtyard with pool, hot tubs and private sun deck.



Access to The Haven Courtyard with pool, hot tubs and private sun deck.



THE HAVEN OWNER'S SUITES

S2 (The Haven Deluxe Owner's Suites) Bedroom with king-size bed, bathroom with whirlpool tub & separate shower, living room with dining area, wraparound balcony. Butler service and concierge available. Size approx. 86 m²; max. occupancy 4 guests

S3 (The Haven Owner's Suites) Bedroom with king-size bed, bathroom with whirlpool tub & separate shower, living room with dining area, balcony. Butler service and concierge available. Size approx. 53 m²; max. occupancy 4 guests

THE HAVEN FAMILY VILLAS & THE HAVEN COURTYARD PENTHOUSES

S4 (The Haven Family Villas) Two bedrooms, one with king-size bed, the other with double sofa bed, two bathrooms (one with tub & separate shower), living room with dining area. Butler service and concierge available. Size approx. 50 m²; max. occupancy 6 guests

S5 (The Haven Courtyard Penthouses) King-size bed, sitting area, balcony. Butler service and concierge available. Size approx. 30-32 m²; max. occupancy 3 guests

THE HAVEN SPA SUITES & THE HAVEN PENTHOUSES

S9 (The Haven Spa Suites) King-size bed, sitting area, hot tub, balcony, complimentary access to the exclusive thermal spa suites. Butler service and concierge available. Size approx. 29 m²; max. occupancy 2 guests

S6 S7 (The Haven Penthouses) King-size bed, sitting area, balcony. Butler service and concierge available. Size S6 approx. 61-76 m², S7 approx. 39-42 m²; max. occupancy 4 guests

MINI SUITES

M9 (Spa Mini Suites) Queen-size bed, sitting area, balcony, complimentary access to the exclusive thermal spa suites. Size approx. 22 m²; max. occupancy 4 guests

M1 M2 M3 M4 M6 MA MB (M2-M4=Family Mini Suites) Queen-size bed, sitting area, balcony (M1 is aft-facing; M6 has a larger balcony). Size M1 approx. 47-54 m², M2-M4, MA, MB approx. 22 m², M6 approx. 27-29 m²; max. occupancy M1 2 guests, M3, M4 3 guests, M2, M6, MA, MB 4 guests

BALCONY STATEROOMS

B5 (Spa Balcony Staterooms) Queen-size bed, sitting area, balcony, complimentary access to the exclusive thermal spa suites. Size approx. 19 m²; max. occupancy 3 guests

B1 B2 B3 B4 B6 BA BB BC BD (B2-B4=Family Balcony Staterooms) Two lower beds, sitting area, balcony (B1 is aft-facing; B6 has a larger balcony). Size B1 approx. 23-48 m², B2 approx. 19-26 m², B3, B4, BA-BD approx. 19 m², B6 approx. 23 m²; max. occupancy B1, B3, B4 3 guests, B2, B6, BA-BD 4 guests

OCEANVIEW & INSIDE STATEROOMS

O1 OA OB OC (O1=Family Oceanview Staterooms) Two lower beds, picture window. Size O1 approx. 20 m², OA-OC approx. 15 m²; max. occupancy O1 5 guests, OA-OC 2 guests

I1 I2 IA IB IC ID IE IF (I1, I2=Family Inside Staterooms) Two lower beds. Size I1, I2, IA, IC approx. 12 m², IB approx. 14 m²; max. occupancy I1, IA, IC, ID 4 guests, IB 3 guests, IE, IF 2 guests

STUDIOS

T1 Designed especially for solo travellers: full-size bed, window to corridor (with one-way glass and shade), separate areas for bathroom, sink and shower, exclusive access to the Studio Lounge with bar service. Size approx. 9 m²; max. occupancy 1 guest